

Technical Document 3

attached to the European XFEL Convention

SITE PLAN

The site plan consists of

- an overview showing the tunnel system of the European XFEL Facility (figure 1)
and
- plans of the three sites where above-ground buildings will be erected, i.e.
 - the European XFEL site DESY-Bahrenfeld (figure 2),
 - the European XFEL site Osdorfer Born (figure 3), and
 - the European XFEL site Schenefeld (figure 4).

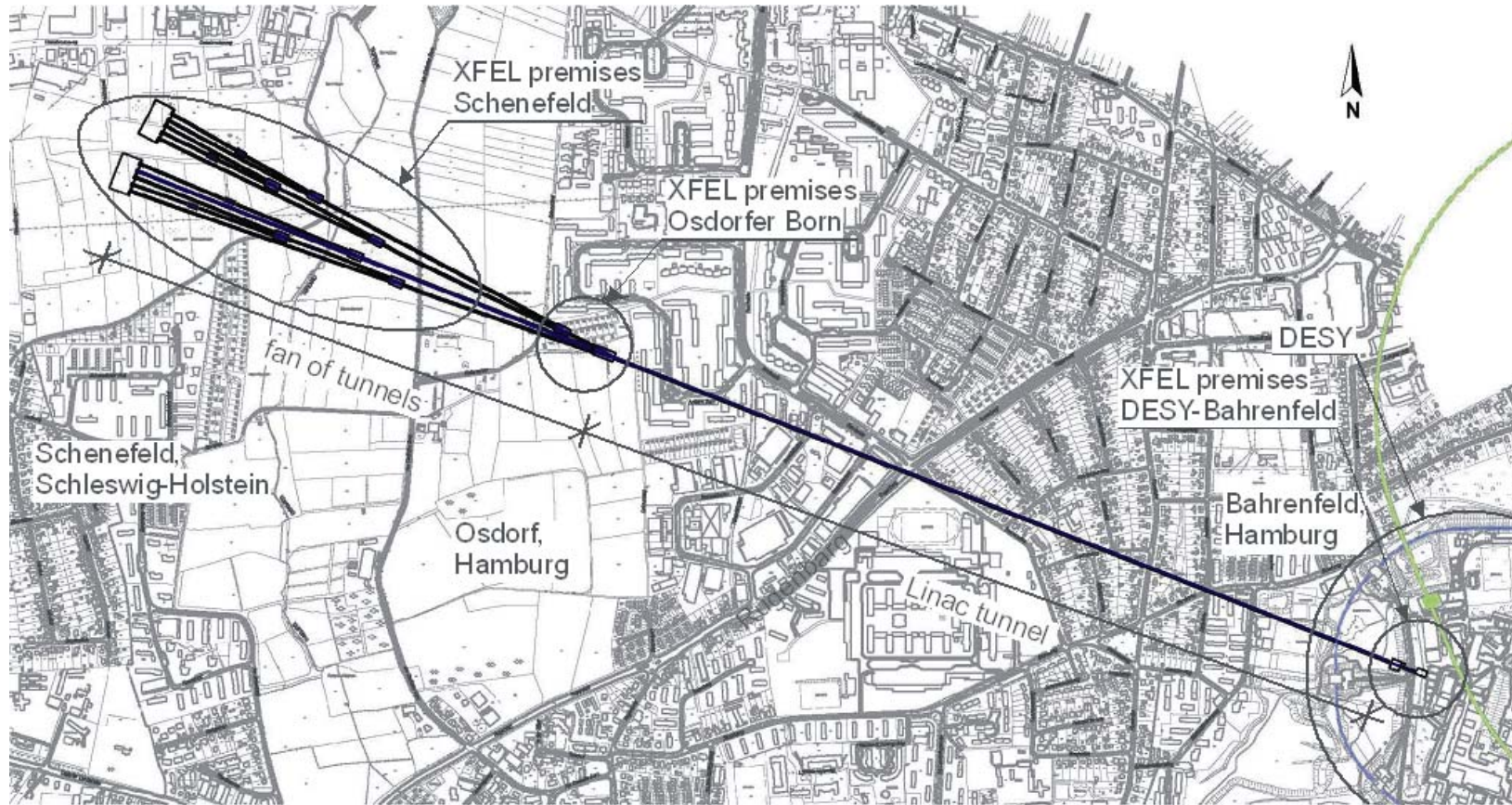

Figure 1: Overview of the tunnel system and the three sites

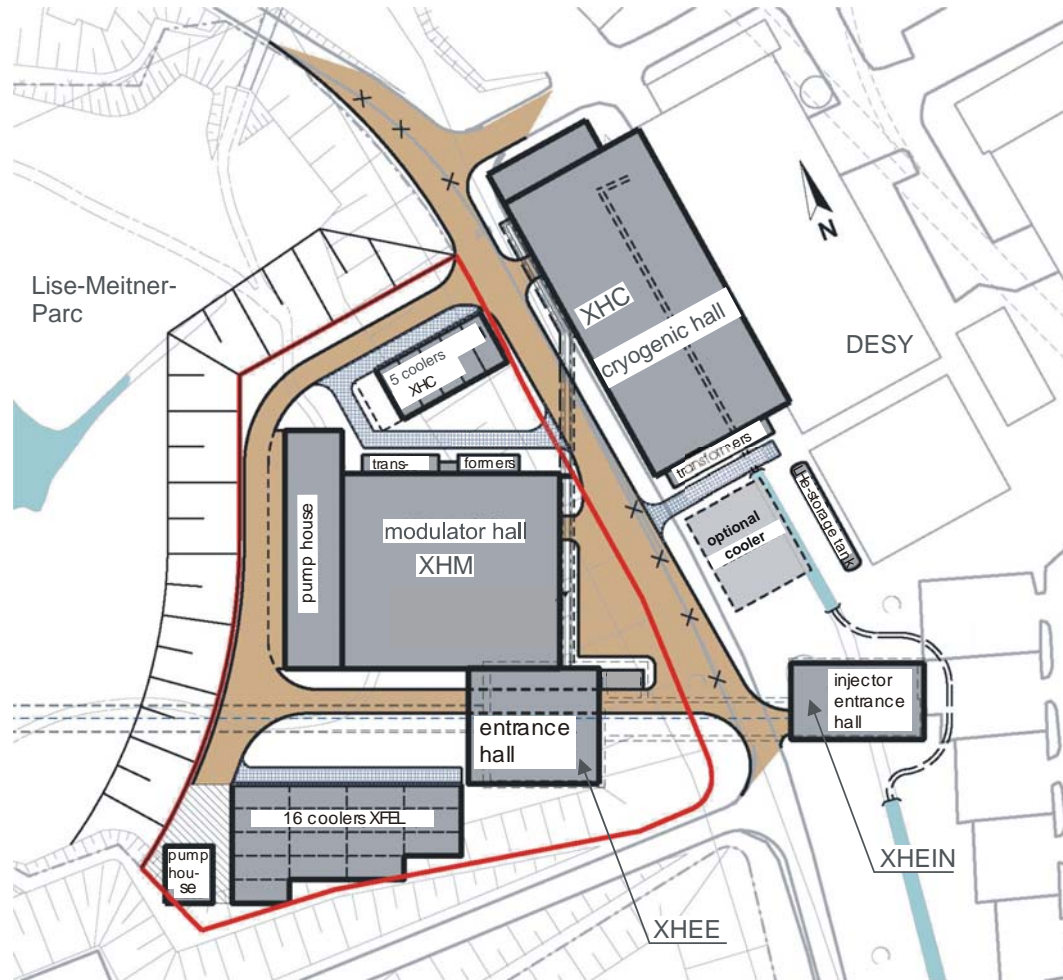

Figure 2: European XFEL site DESY-Bahrenfeld

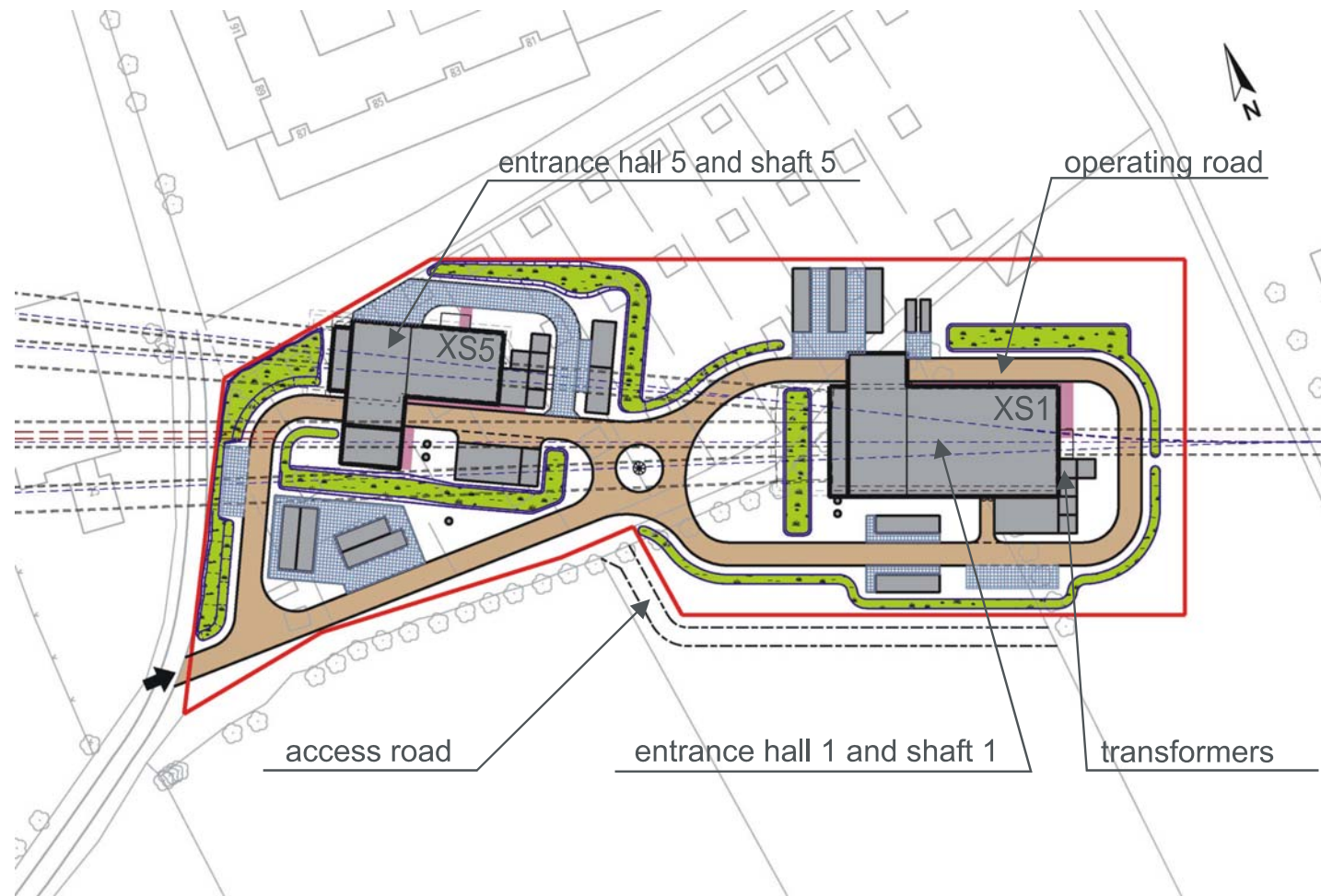

Figure 3: European XFEL site Osdorfer Born

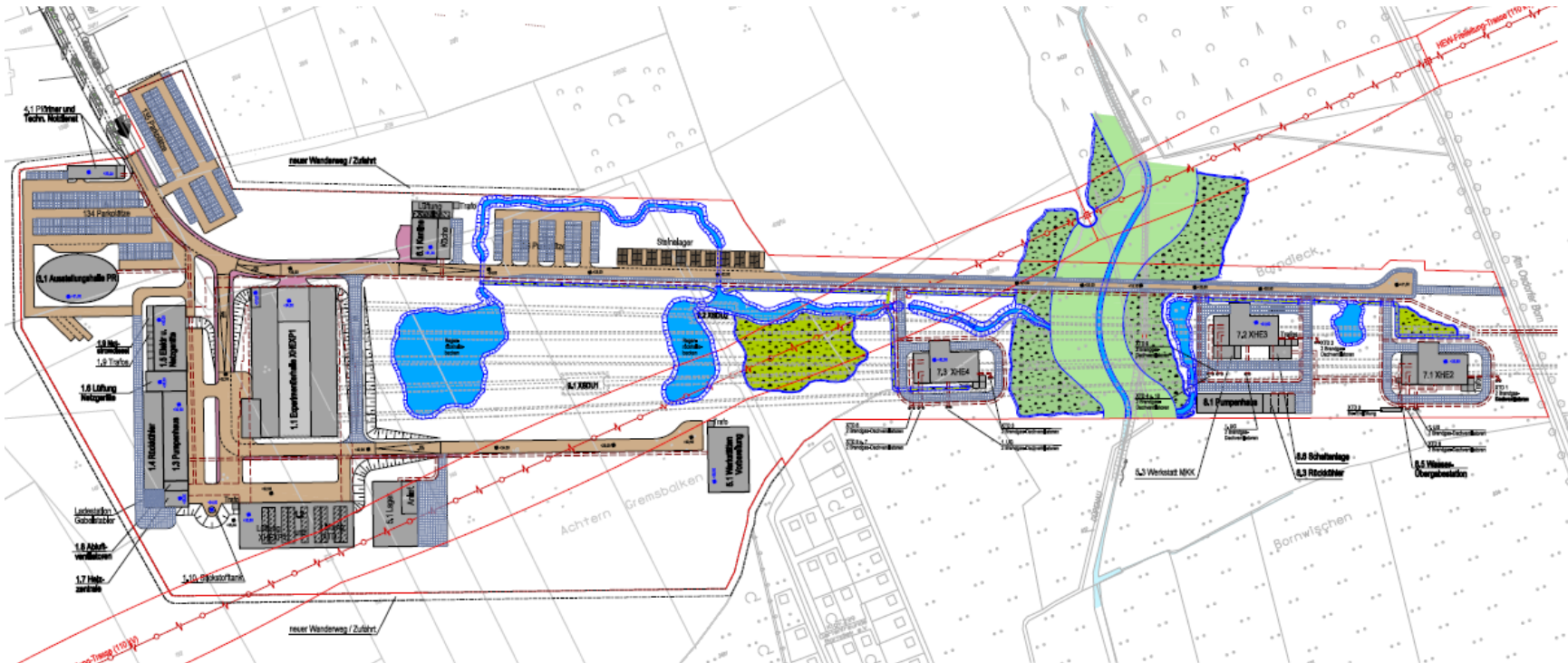

Figure 4: European XFEL site Schenefeld